

REB34

系列多线圈双回路电磁制动器

REB34 Multi-pole Double-loop Electromagnetic brake

产品特点

- 多线圈弹簧加压制动, 力矩为REB04系列的2倍
- 无石棉摩擦片, 温升高、节能, 符合RoHS要求
- 手动释放方式可选
- 微动开关、安装孔径大小可选
- 低噪音方式可选

Product Features

- Multi-pole spring-applied brake, Braking torque is as 2 times as REB04
- None asbestos in friction plate, accord to ROHS Standard
- Optional manual-releasing
- Optional installation bore diameter and microswitch
- Optional low-noise design

应用范围

- 电梯曳引机
- 制动电机
- 仓储设备

Application

- Elevator Tractor
- Braking Motor
- Warehousing Facilities

技术参数

Technical Data

型号 Model	扭矩 Torque (N.m)	最大工作转速 Max. Work Speed (rpm)	安装孔径d Installation Pore Diameter (mm)	额定电压 Rated Voltage (V-DC)	保持功率 Sustaining Power(W)	过励磁功率 Overexcited Power(W)
REB3418	2×225	3000	35/40/45	205/103V	2×51	2×204
REB3420	2×280	3700	35/40/45/50	205/103V	2×51	2×204
REB3422	2×300	3000	35/40/45/50	205/104V	2×66	2×264
REB3425	2×610	3000	40/45/50/55/60/65	205/103V	2×66	2×264

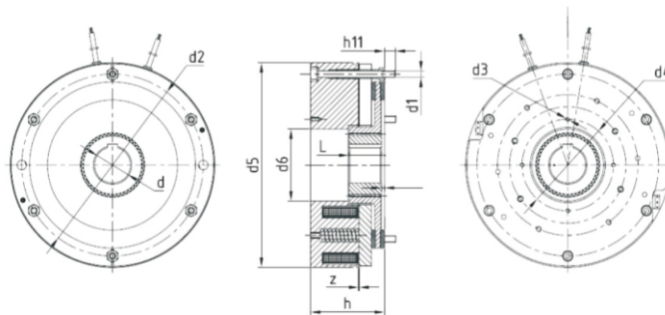

尺寸单位: mm

型号 Model	d1	d2	d3	d4	d5	d6 ^{H8}	h	h11	L	z
REB3418	6×M8	196	4×M6	110	235	66	82.5	15.5	40	0.3
REB3420	6×M10	230	4×M6	110	260	85	80	15.5	40	0.3
REB3422	6×M8	229	4×M6	110	260	66	84	12.8	40	0.3
REB3425	6×M10	278	4×M6	140	315	115	94.5	17	50	0.3